

## How to wear Samsung earbuds?

*Before wearing the earbuds, make sure to attach the earbud tips and wingtips to the earbuds.*

*Please note:*

- *Do not touch the heart rate sensor while putting the earbuds in the ear. If the heart rate sensor contacts the skin before wearing, it may start working unintentionally*
- *The heart rate sensor will not work if it is not contact with the ear. Use the wingtips and earbuds tips that fit the ears*
- *Follow all posted warnings and directions from authorized personnel in areas, such as aeroplanes and hospitals*

**1 Check the direction of each earbud and put them into the ears accordingly with the wingtip facing upwards until it sit comfortably in the ears**



*Inserting earbuds into ears*

**2 Adjust the earbuds by rotating them to the left or right to fit the ears. The heart rate sensor will automatically detect when the earbuds are put on. The earbuds will automatically enters Bluetooth pairing mode and emit a sound**

## How to clean earbuds for Samsung Gear IconX?

*If the audio quality of the earbuds are poor, check the following:*

- *Wireless network services may be disabled due to issues with the service provider's network. Ensure to keep the earbuds away from electromagnetic waves.*
- *Ensure that the earbuds and the other Bluetooth device are within the maximum Bluetooth range (5 m). The distance may vary depending on the environment the devices are used in*
- *You may experience drops in volume or noise depending on the connected device's volume. To avoid this, adjust the connected device's sound appropriately*

### *Basic Maintenance of the earbuds*

- *Before wearing the earbuds, make sure to clean the inner side of the ear*
- *Always wear and use earbuds in dry condition*

- After using the earbuds, wipe the inside of the earbud tip with soft and dried towel to remove dust, earwax, or oil from your skin

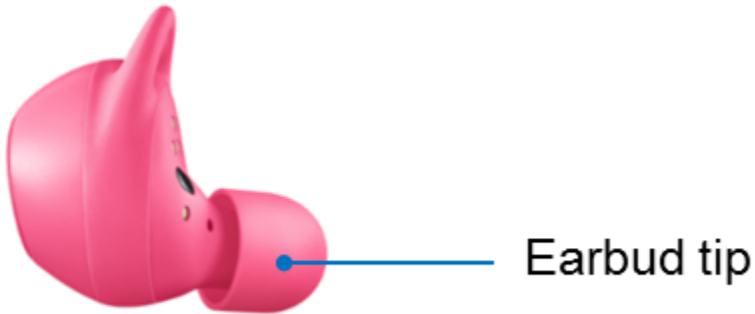

*Earbud tip*

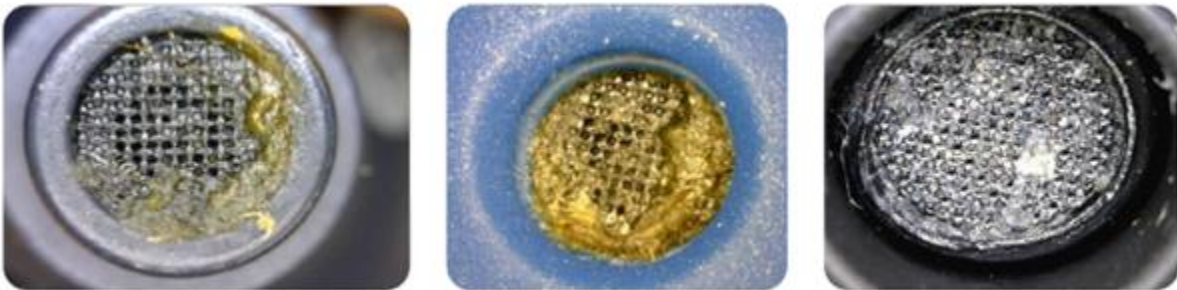

*Dirty mesh part of earbud receiver*

#### *How to clean earbuds*

**1 Take off earbud tips from earbuds smoothly. Do not detach the earbud tip from earbud excessively as it may tear**

**2 Use a cotton swab and dried brush to remove any debris and foreign materials.**

*Please note: Do not use liquid like alcohol or soapy water for cleaning earbuds as Gear IconX is not water resistant*



### *Cleaning Earbuds Tip*

**3 If foreign substance is still present, try brush the earbuds again to dislodge the remaining**

**4 After completed cleaning, please assemble the earbud tip to earbud properly. Cover the latch at the bottom of the earbud with the earbud tip like below**

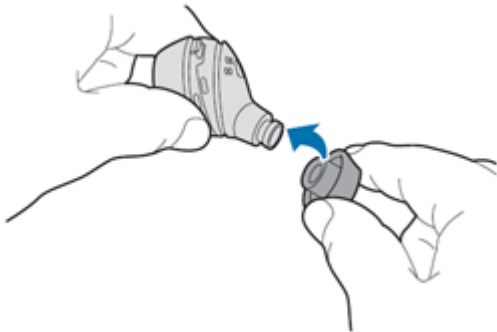

### *Reassemble earbud tips*

*Please note: If the audio quality is still poor after cleaning the earbuds, please visit the nearest authorized [Samsung Service Centre](#) to exchange mesh part of earbuds.*

**How to set the main earbud for Gear IconX?**

*Set the main earbud to use the call feature and to record exercise information. The right earbud is preset as the main earbud.*

*Please note: The earbuds may not automatically reconnect to the mobile device if the main earbud is changed. If this happens, you must manually search for the earbuds and connect the devices.*

*To change the main earbud, follow these steps:*

### **1 On the Apps screen of the mobile device, tap Samsung Gear**



*Tap Samsung Gear*

### **2 Tap Settings**

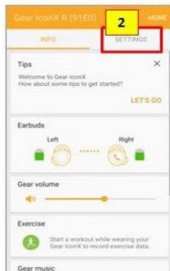

*Tap Settings*

### **3 Tap Select main earbud**

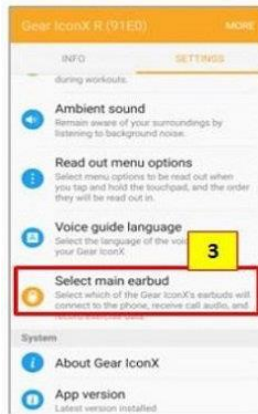

*Tap Select main earbud*

#### **4 Then select the earbud to use as the main earbud**



*Select the earbud to be main*

### **How to couple a new earbud with existing in Gear IconX**

*To connect an existing earbud with a new one to mobile device, both earbuds need to be coupled newly:*

**1 Push the cover open button to open the charging case**

**2 Check the direction of each earbud and insert them into the left and right slots of the charging case**

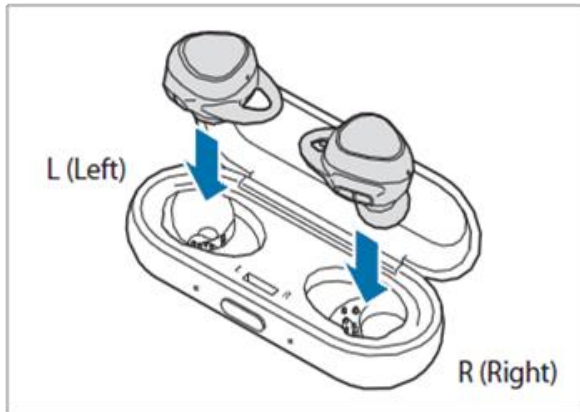

*Insert the earbuds into the case*

### **3 Close the charging case**



*Close the charging case*

### **4 Connect with a PC**

### **5 Run Gear IconX Manager**





**6 Manager App notices coupling is needed automatically and a pop up appears**

**7 Press Yes button to make a couple**

**8 Once coupled, they will be automatically connected in the future when you put both earbuds in your ears**

**How to use the touchpad for Samsung earbuds?**

<b>Tapping</b>		• <i>Pause or resume playback</i>
----------------	--	-----------------------------------

		
<b>Double-tapping</b>		<ul style="list-style-type: none"> <li>• Skip to the next song</li> <li>• Answer or end a call</li> <li>• Place the current call on hold</li> <li>• Switch between the current call and the held call</li> </ul>
<b>Tapping three times</b>		<ul style="list-style-type: none"> <li>• Skip to the previous song</li> </ul>
<b>Tapping and holding</b>		<ul style="list-style-type: none"> <li>• Reject a call</li> <li>• Turn off the microphone</li> </ul>



		<ul style="list-style-type: none"><li>• <i>Retrieve the held call</i></li><li>• <i>Hear the readout menus</i></li></ul>
<b>Dragging upwards or Downwards</b>		<ul style="list-style-type: none"><li>• <i>Adjust the volume</i></li></ul>