

# HyperX Cloud Revolver Headset





---

**Part Numbers: HX-HSCR-BK/AS HX-HSCR-  
BK/EE  
HX-HSCR-BK/EM  
HX-HSCR-BK/LA  
HX-HSCR-BK/NA**

## **Introduction**

HyperX Cloud Revolver™ has a wider audio range that creates depth and width for improved audio precision. Get the competitive edge by hearing your opponents' location more accurately, even when they're further away. Re-engineered audio profiles create a larger sound stage that's ideal for FPS and open-environment gameplay and for a concert-hall-like experience when listening to music. Next-generation 50mm drivers direct sound into the ear for precise audio positioning, making HyperX Cloud Revolver the only headset you need for both PC and console gaming.



HyperX Cloud Revolver Headset  
Detachable microphone  
Audio control box

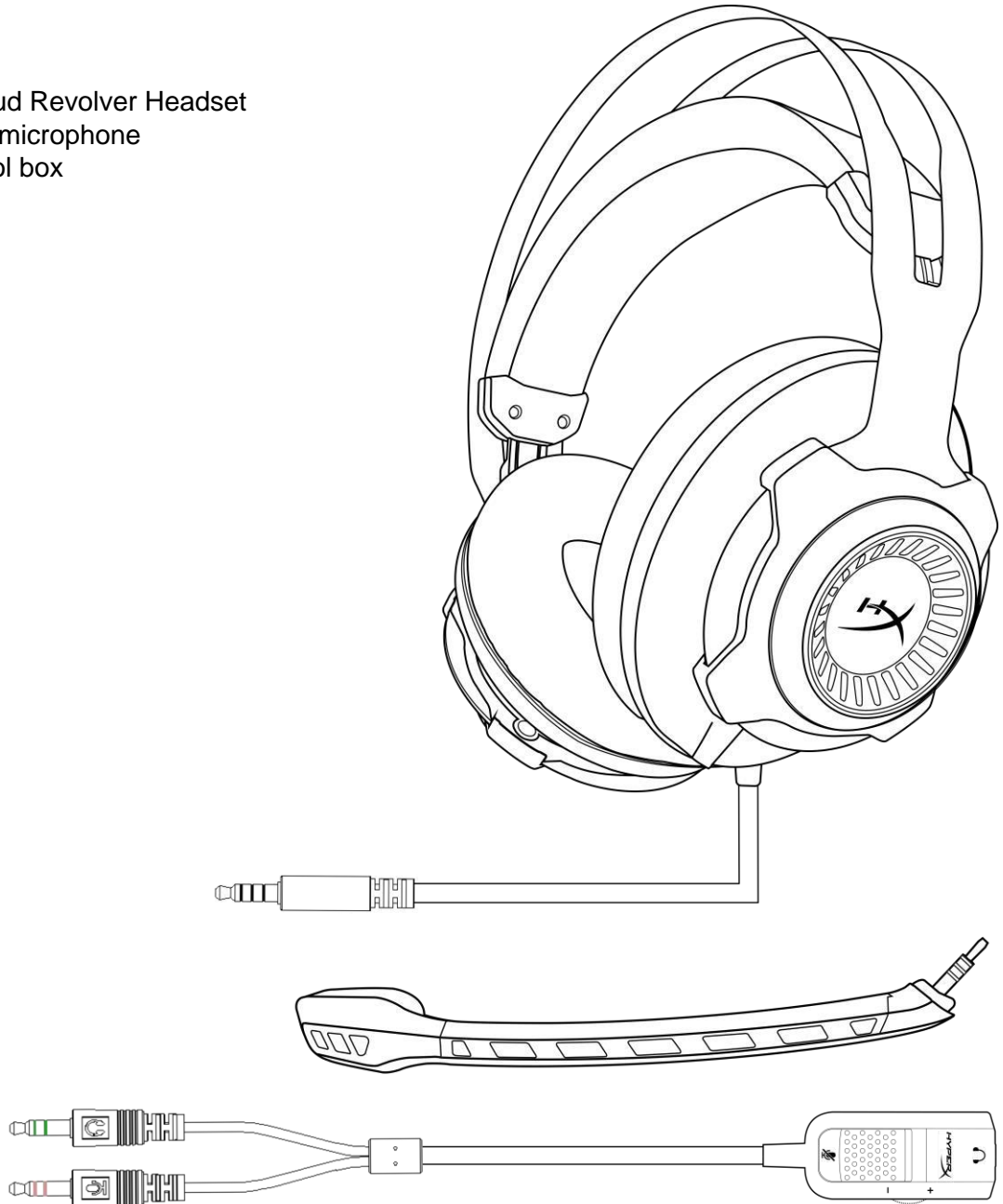

**What's included:**

- 
- 
-



## Features:

- Studio-grade sound stage
- Signature HyperX memory foam with premium leatherette
- Durable steel frame
- Detachable noise-cancellation microphone
- Next-generation directional 50mm drivers □ Multi-platform compatibility

## Technical specifications:

### Headphone

- Driver: Dynamic, 50mm with neodymium magnets
- Type: Circumaural, closed back
- Frequency response: 12Hz–28,000 Hz
- Impedance: 30  $\Omega$
- Sound pressure level: 104.5dB SPL/mW at 1kHz
- THD: < 2%
- Input power: Rated 30mW, maximum 500mW
- Weight: 360g
- Weight w/ mic: 376g
- Cable length and type: Headset (1m) + audio control Box (2m)
- Connection: Headset - 3.5mm plug (4 pole) + Audio Control Box - 3.5mm stereo and mic plugs

### Microphone

- Element: Electret condenser microphone
- Polar pattern: Uni-directional, Noise-cancelling
- Frequency response: 50Hz-18,000 Hz
- Sensitivity: -40dBV (0dB=1V/Pa, 1kHz)

### Overview

#### A.



- B.** Durable steel Frame
- C.** Suspension headband
  - Detachable noise cancellation
- Attached cable w/ 4 pole 3.5mm plug
- Audio control box with 3.5mm stereo and mic plugs (2m)

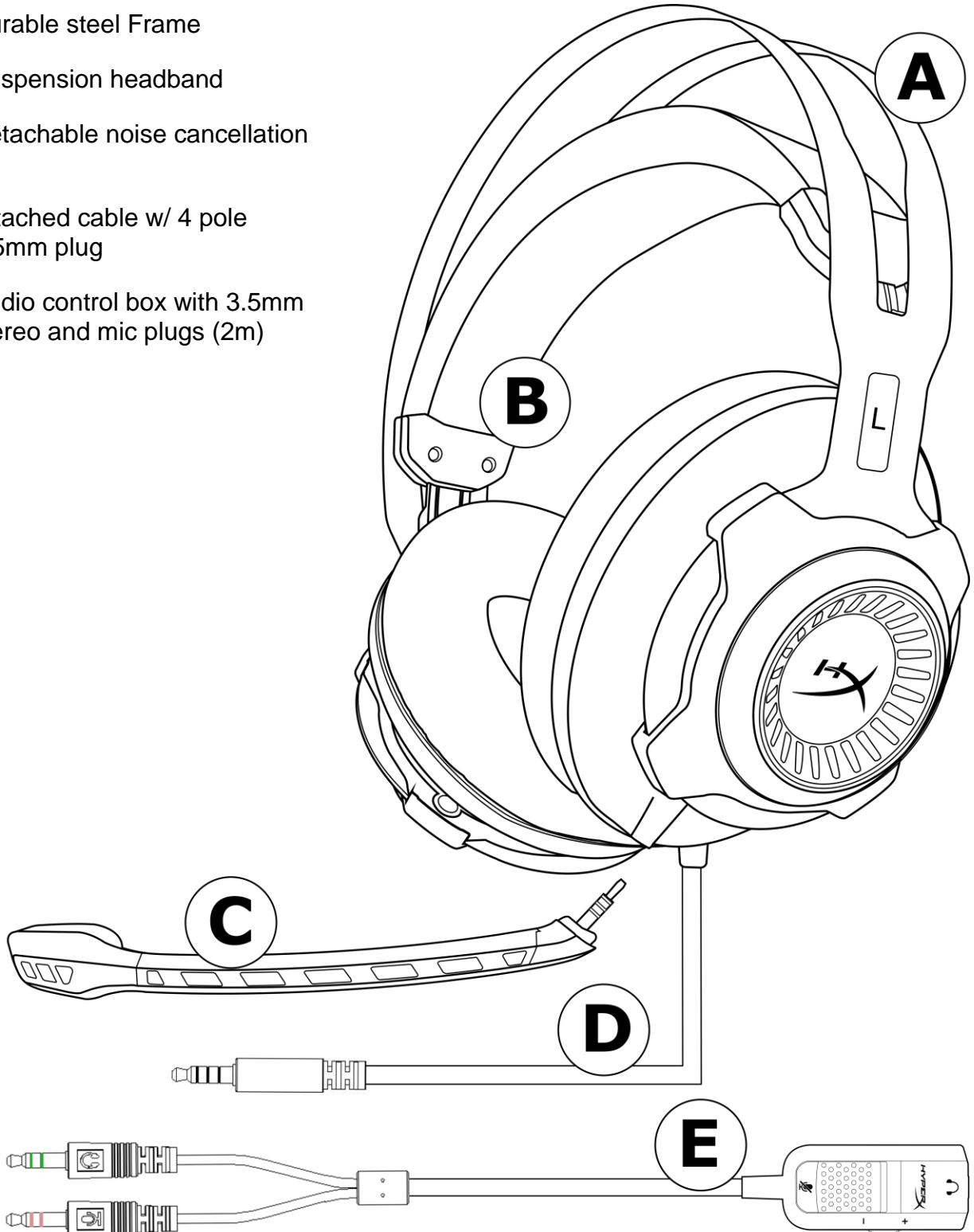

mic **D.**



**E.**

### **Audio control box operation**

The audio control box contains a volume dial to adjust the headphone output volume and a microphone mute slider to mute the microphone output.

To increase the volume of the headset, rotate the volume wheel towards the + sign (anticlockwise). To reduce the volume, rotate the volume wheel towards the – sign (clockwise).

To mute the microphone output, slide the microphone mute button to the down position. To activate the microphone output, slide the microphone mute button to the up position.

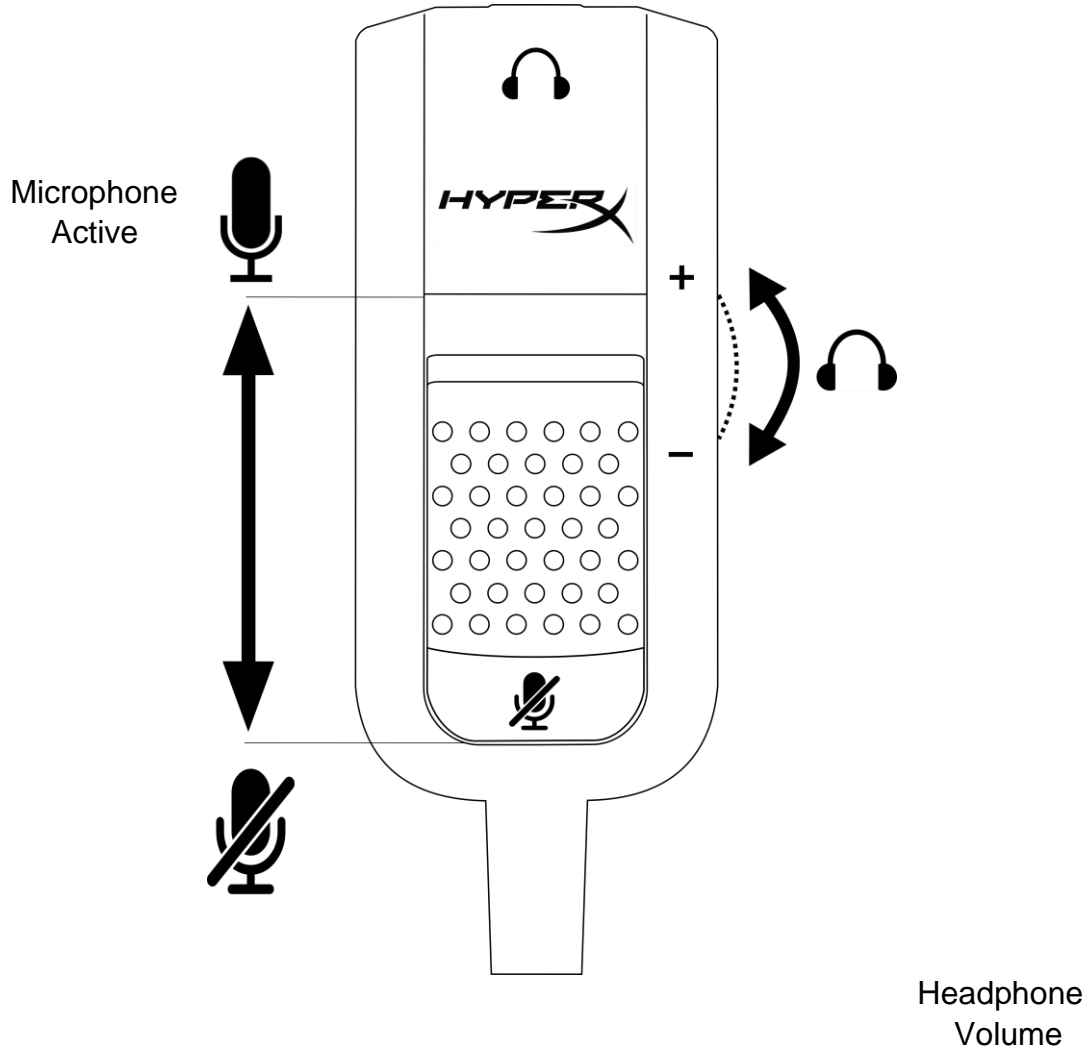



## Usage (PC)

To connect the headset to your computer (or other device) that has both a headphone jack and a microphone jack, connect the headset's 3.5mm plug to the female jack on the audio control box. The audio control box has two 3.5mm jacks. The audio plug, which has green stripes, plugs into the port signified by a green input or headphone symbol 🎧. The extension cable microphone plug, which has pink stripes, plugs into the port signified by a pink input or a microphone symbol 🎤.

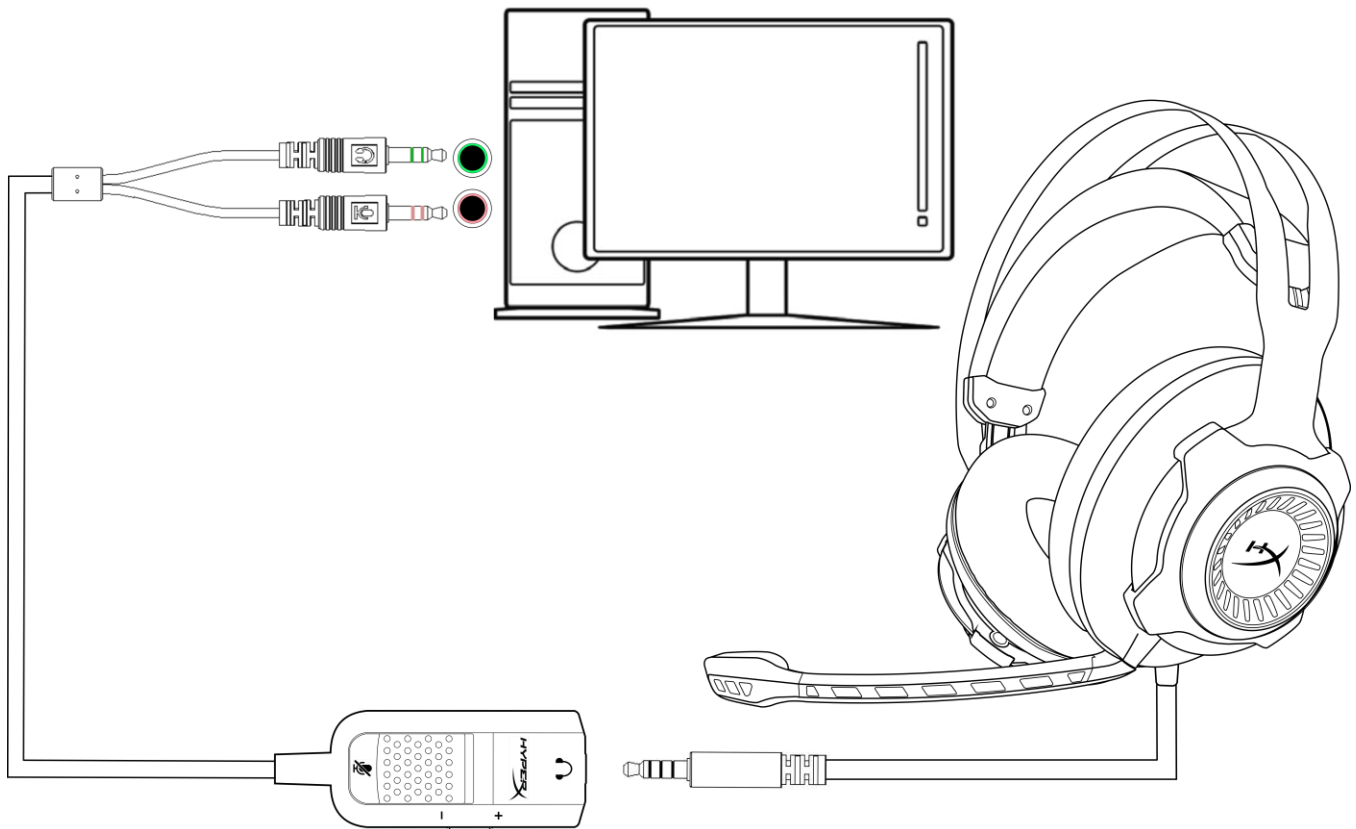

### *Using with PC extension cable*

## Usage (Xbox One)

To use the headset with Xbox One™, connect the 3.5mm plug on the headset directly to the 3.5mm jack on the Xbox One controller.



\* If your Xbox One controller does not have a 3.5mm jack you will need the Xbox One Stereo Headset adapter (sold separately) that plugs into the Xbox One controller (pictured below).

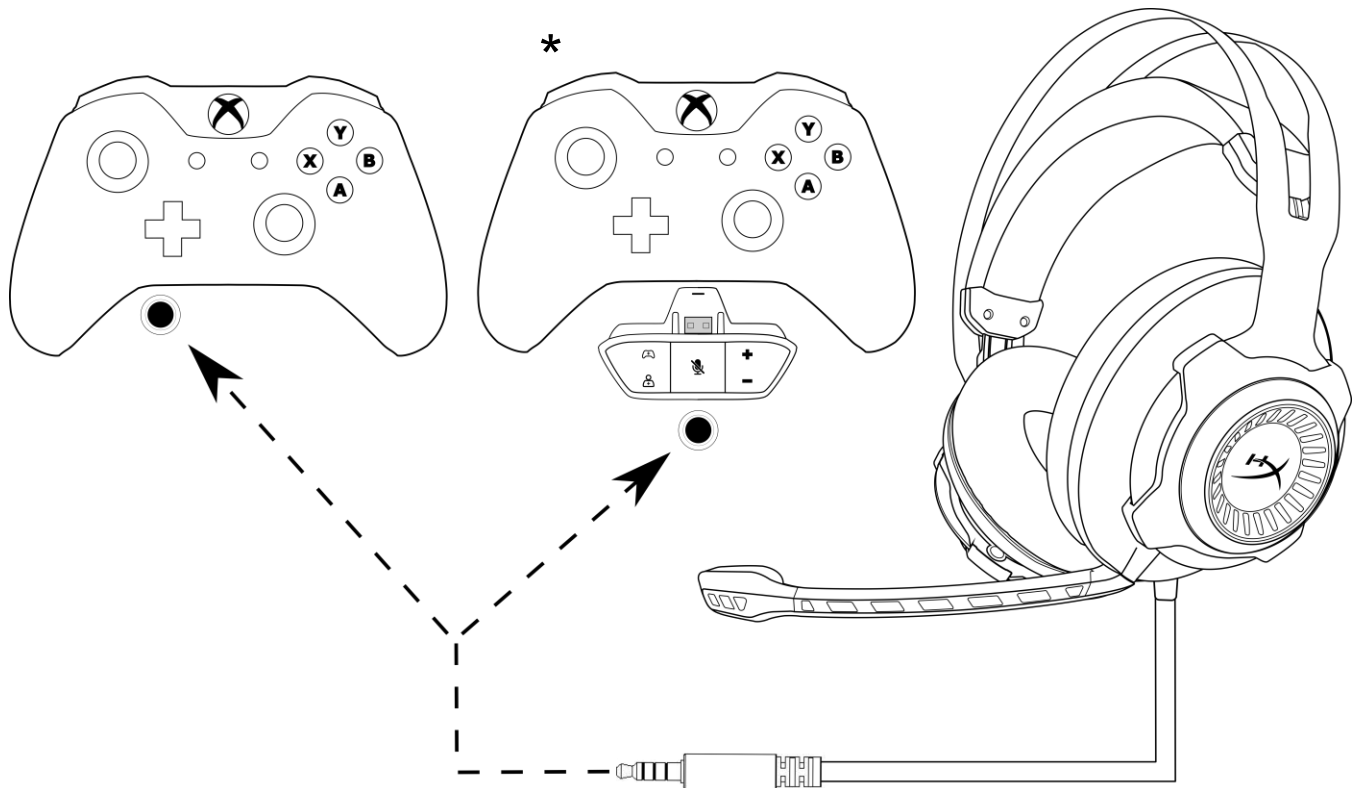

### *Using with Xbox One<sup>TM</sup>*

#### **Usage (PlayStation 4)**

To use the headset with PlayStation<sup>®</sup> 4 (PS4<sup>™</sup>), connect the 3.5mm plug on the headset directly to the PS4 game controller and follow these steps:



1. Turn on your PS4 game console.
2. Navigate to the Settings menu and select it.
3. Highlight the '**Devices**' menu option and select it.
4. Scroll down to '**Audio Devices**' and select it.
5. Choose '**Output to Headphones**' and select '**All Audio**'.

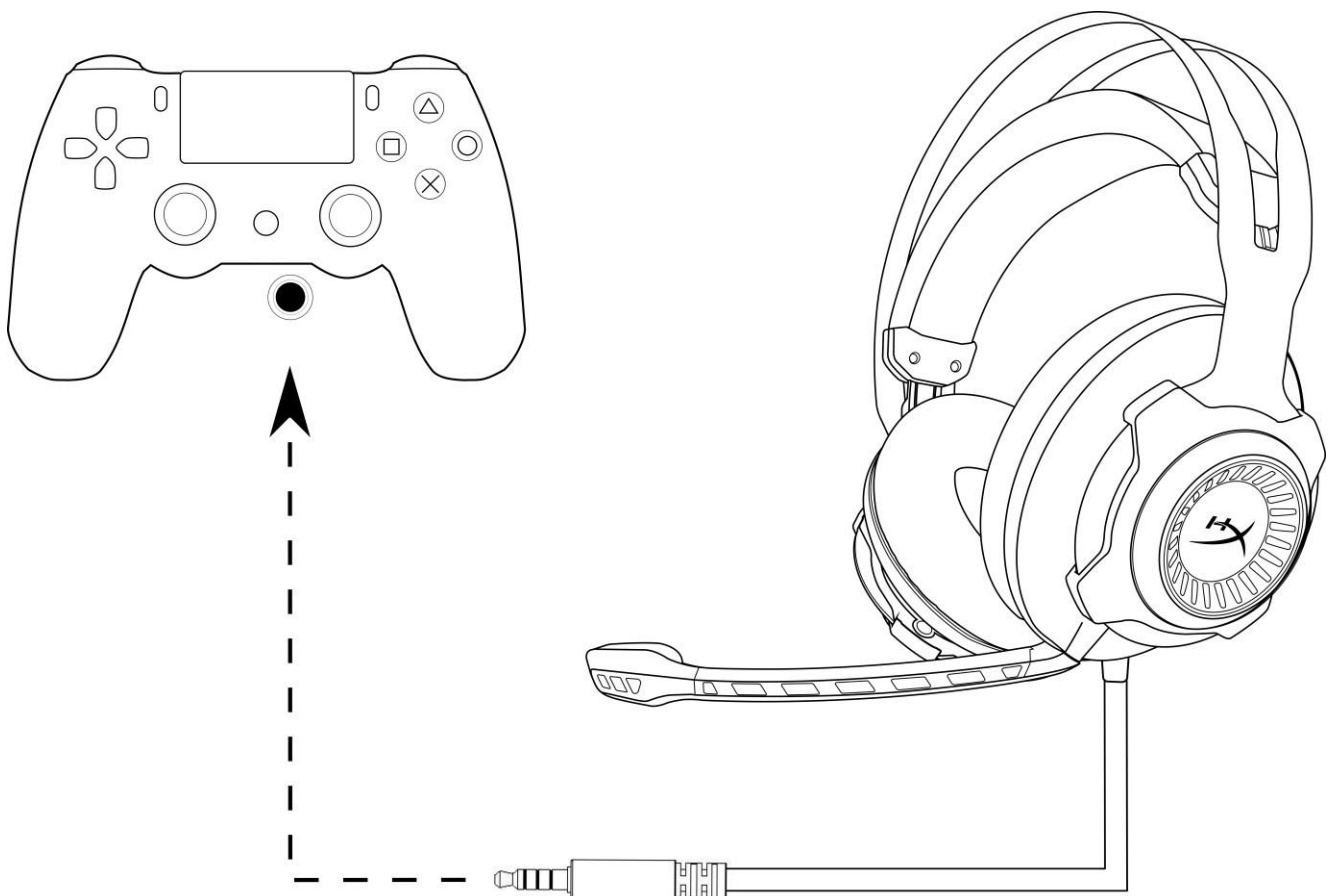

### **Using with PS4<sup>TM</sup>**

#### **Usage (Wii U)**

To use the headset with Wii U<sup>TM</sup>, connect the 3.5mm plug on the headset directly to the Wii U gamepad controller.

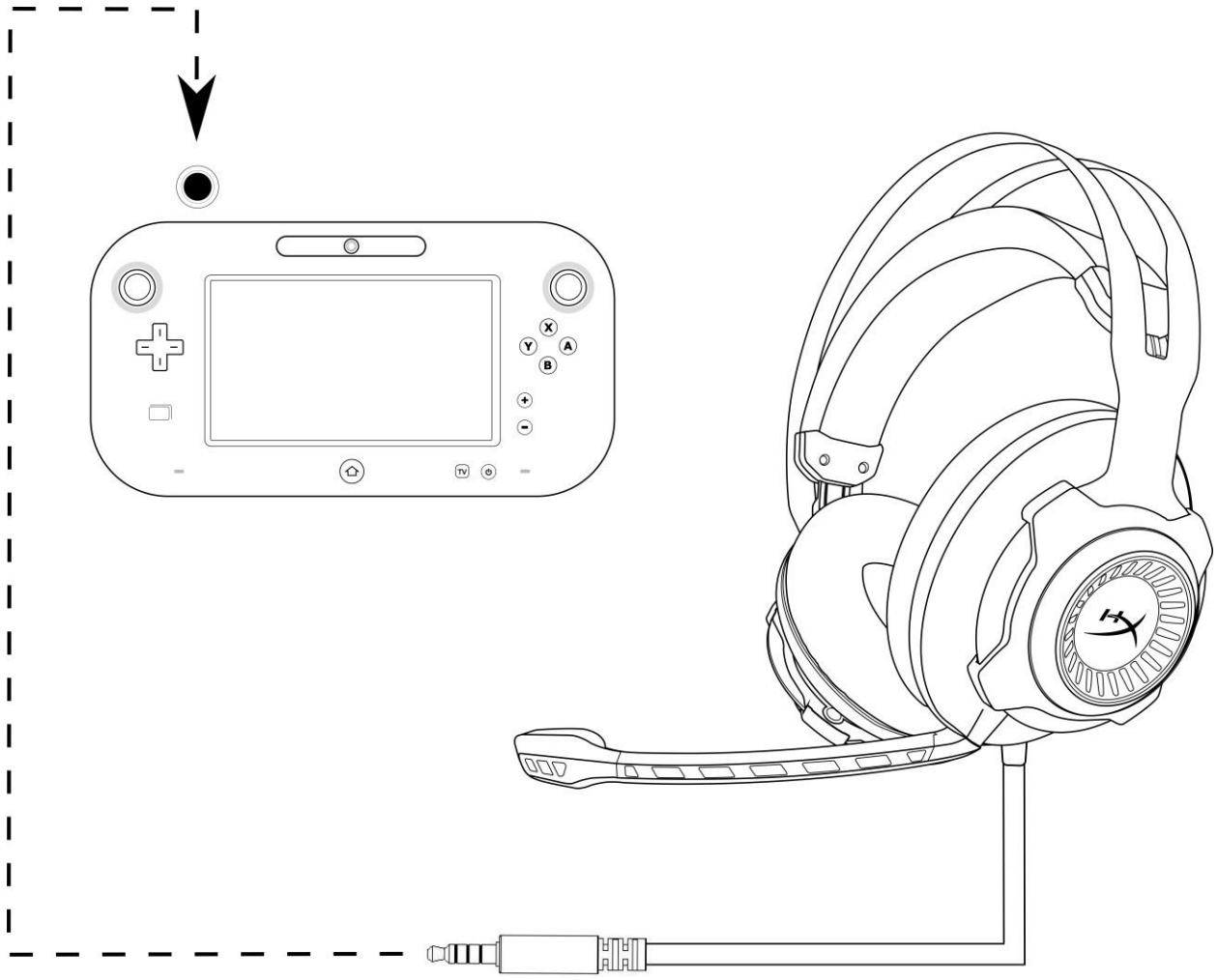

**Using with Wii U™**



## Usage (mobile device)

To use the headset with a mobile device (or other device) with a headset jack (4 pole CTIA), connect the 3.5mm plug directly into the headset jack on your device.

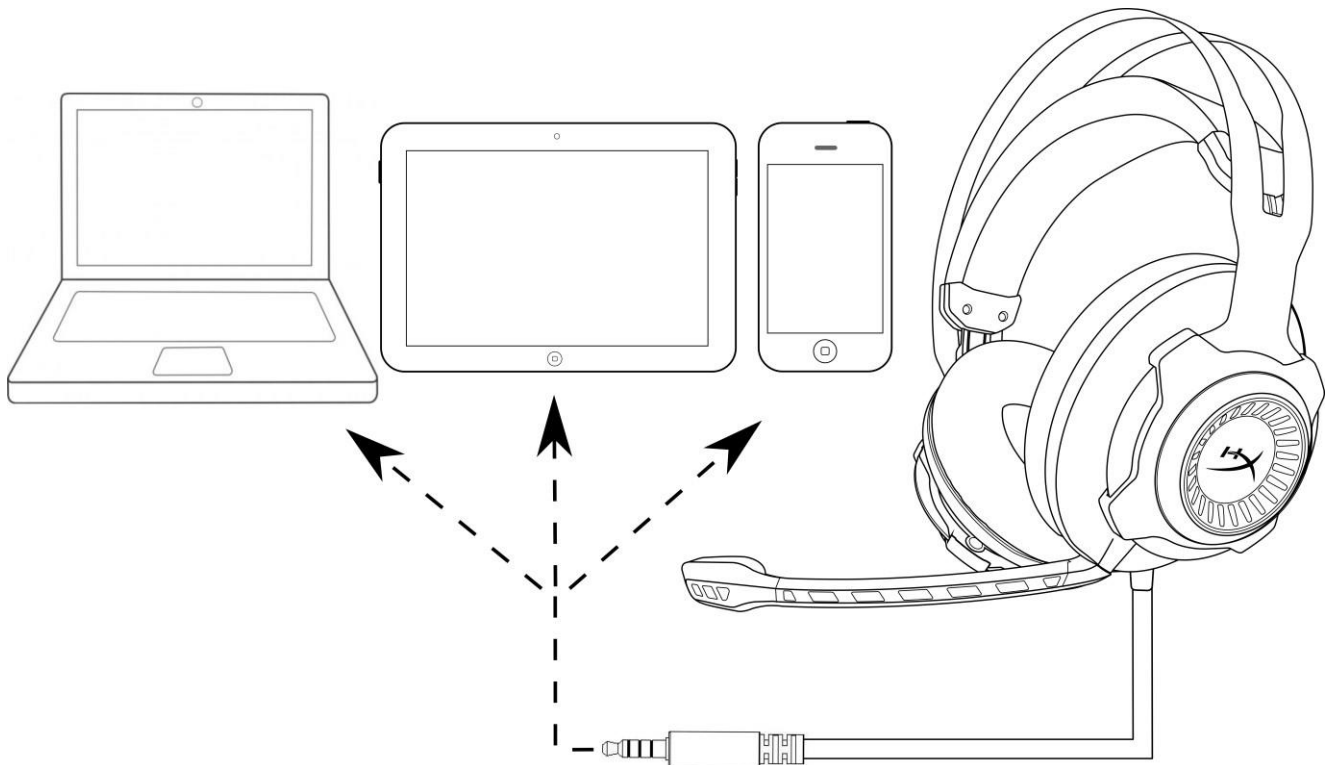

***Using with mobile device (phone, tablet or notebook)***